

P.U.D. PLAN URBANISTIC DE DETALIU

3. ECHIPAREA TEHNICO-EDILITARA

LEGENDA

- Limita teren studiat
- Limita gospodarie
- Constructii existente (C.I.=494,50 mp)
- Constructii propuse demolarii (C.I.=117,50 mp)
- Constructii propuse constructii (C.I.=398,50 mp)

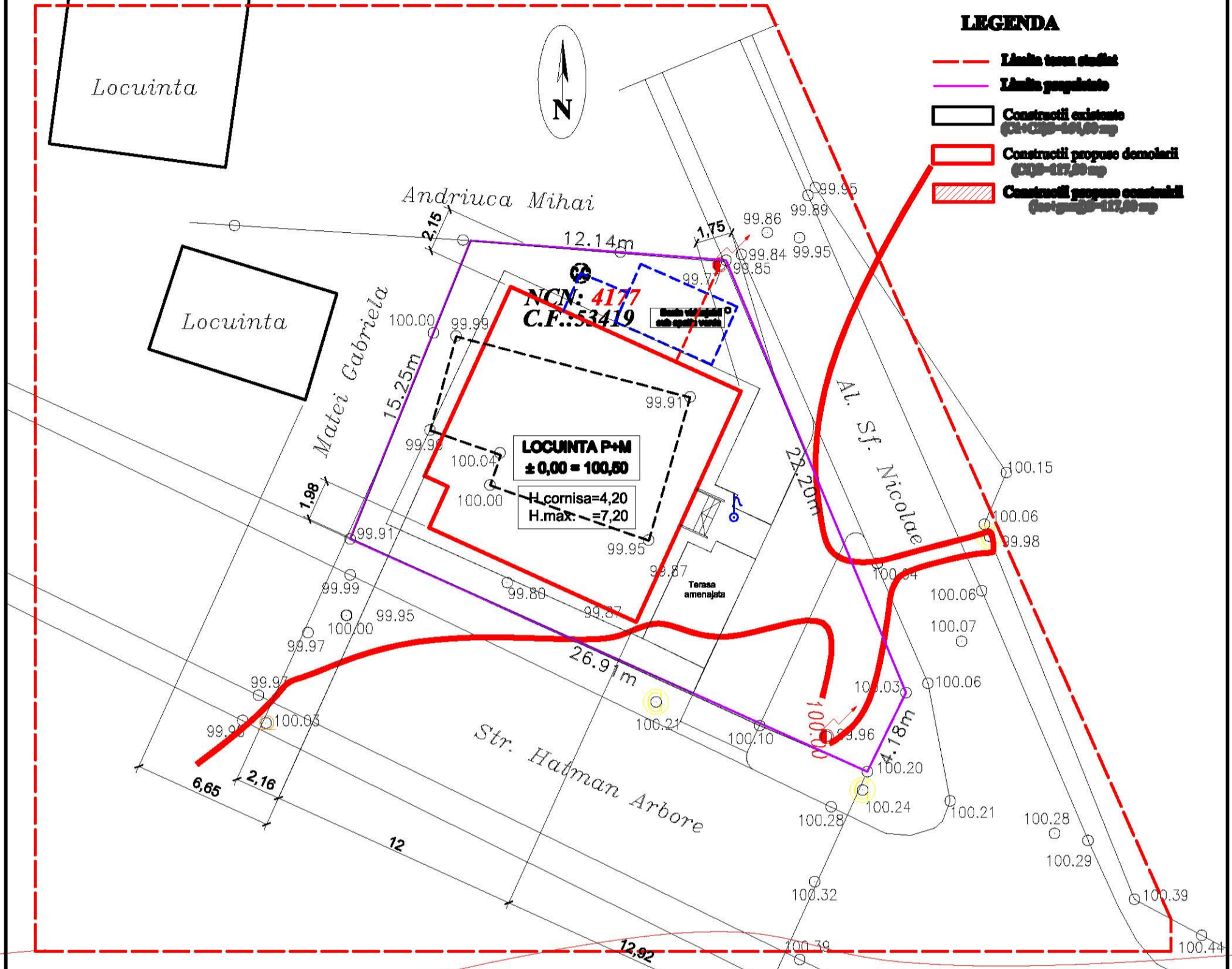

LEGENDA

- Aerisire gaz
- Stalp electricitate
- Cistea
- Cladiri
- Pom

Steren masurat = 401.28 mp
Steren acte = 540.00 mp

Suprafata teren = 540,00 mp
 Constructii exist. = 141,50mp

BILANTUL SUPRAFETELOR

	EXISTENT
Suprafata teren	540,00 mp
CONSTRUCTII	S= 141,50 mp
TEREN ARABIL	
CURTI CONSTR.	S= 398,50 mp

P.O.T.
 EXISTENT 26,2 %
 C.U.T.
 EXISTENT 0,53

 S.C. 700 DESIGN PROJECT S.R.L. URBANISM	Verificator (NUME /PRENUME)	Cerinta(A1)
	PROIECT: Plan Urbanistic de Detaliu Construire locuinta P+M, Str. Hatman Arbore nr.74	
CLIENT: SARGHI IOAN, STRADA HATMAN ARBORE NR. 74	PROIECT NR.: 74/2011	
Coord.urbanistic	ARHITECT: M.MIHAILESCU	SCARA: 1:200
PROIECTAT ARHITECTURA	ARHITECT: DOREL BURSUC	ECHIPAREA TEHNICO-EDILITARA
DESENAT	ARHITECT: DOREL BURSUC	
	DATA: iunie/2011	FAZA: P.U.D. NR.PLANSA: A.3.