

P.U.D. PLAN URBANISTIC DE DETALIU

2. REGLEMENTARI URBANISTICE

LEGENDA

- Limita teren studiat
- Limita proprietate
- Constructii existente S=48,00 mp
- Constructii propuse demolarii S=48,00 mp
- Constructii propuse constructii (loc+gara) S=141,50 mp
- Carosabil
- Pietonal dalat
- Pietonal
- Curti-constructii
- Spatii verzi
- Arabil

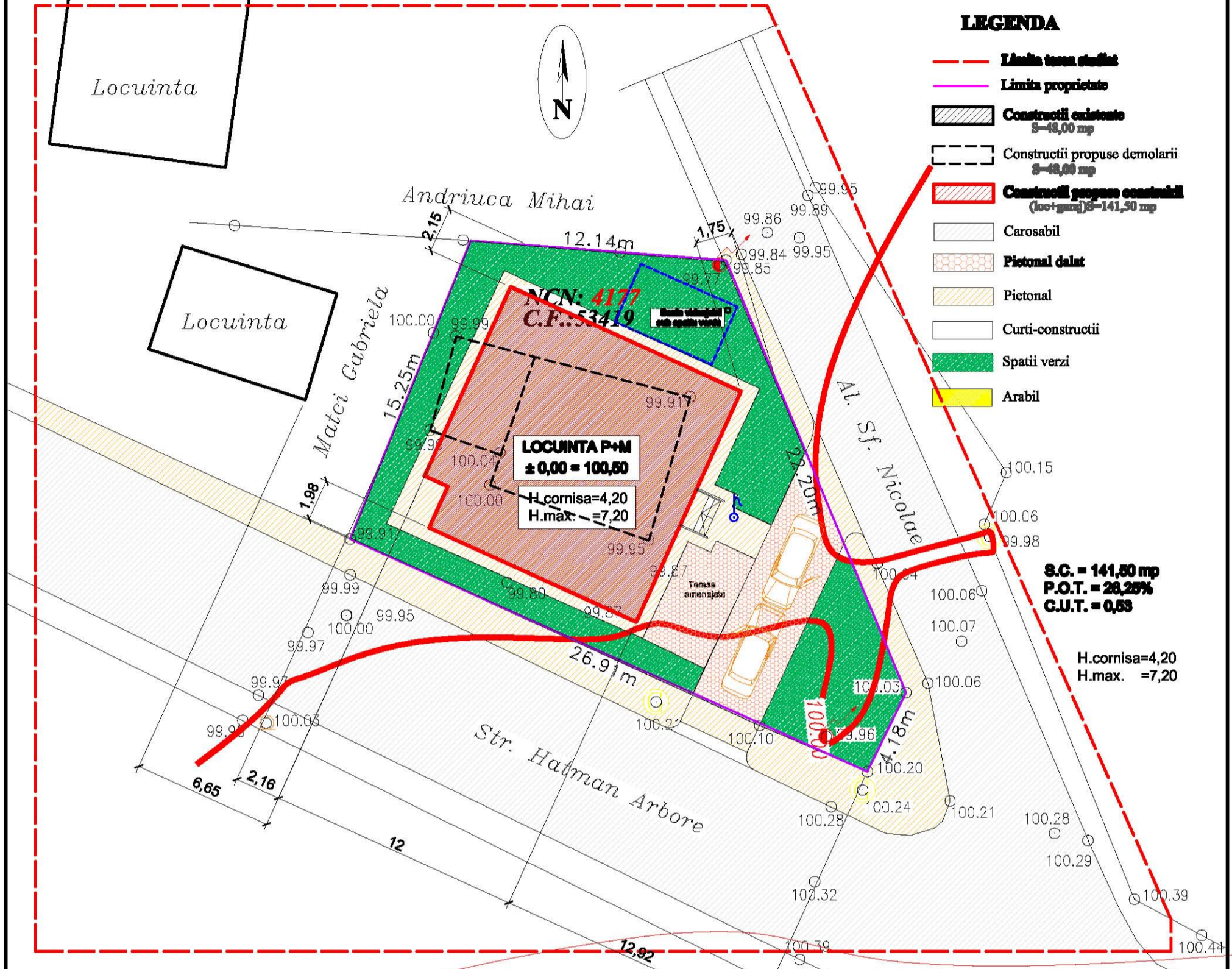

S.C. = 141,50 mp
P.O.T. = 26,2%
C.U.T. = 0,53

H.cornisa=4,20
H.max. =7,20

LEGENDA

- Aerisire gaz
- Stalp electricitate
- Cistea
- Cladiri
- Pom

Steren masurat= 401.28 mp
Steren acte= 540.00 mp

Suprafata teren = 540,00 mp
Constructii exist. = 48,00mp

BILANTUL SUPRAFETELOR

	EXISTENT
Suprafata teren	540,00 mp
CONSTRUCTII	S= 141,50 mp
TEREN ARABIL	
CURTI CONSTR.	S= 398,50 mp

P.O.T.
EXISTENT 26,2 %
C.U.T.
EXISTENT 0,53

<p>S.C. 788 DESIGN PROJECT S.R.L. <small>STRADA HATMAN ARBORE NR. 74, SECTOR 7, BUCURESTI</small> URBANISM</p>	Verificator (NUME /PRENUME)	Cerinta(A1)	
	PROIECT: Plan Urbanistic de Detaliu Construire locuinta P+M ,Str.Hatman Arbore nr.74		PROIECT NR. : 74/2011
CLIENT: SARGHI IOAN,STRADA HATMAN ARBORE NR. 74	SCARA: 1:200	REGLEMENTARI URBANISTICE	
Coord.urbanistic ARHITECT: M.MIHAILESCU PROIECTAT ARHITECTURA ARHITECT: DOREL BURSUC DESENAT ARHITECT: DOREL BURSUC	DATA: iunie/2011		